

## Wakefield Exchange Easy Read Guide



### Wakefield Exchange

#### Venue Guide

Easy read guide to help you plan your visit.

**Wakefield Exchange** is an indoor meeting and events venue.

The venue is in **Wakefield City Centre**.

The venue hosts **events** such as:

- Live music
- Art & Exhibitions
- Film Screenings
- Workshops
- Talks
- Comedy nights

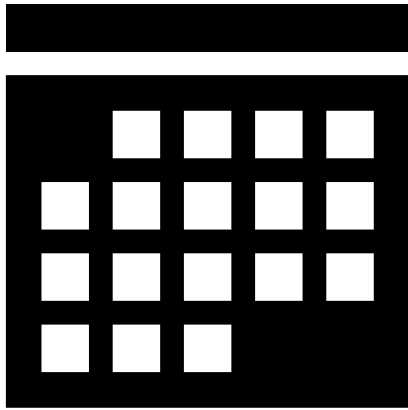

The venue opening times are

**Monday** Closed

**Tuesday** and

**Wednesday** 9:00am to 4:00pm

**Thursday** and **Friday** 9:00am to 10:30pm

**Saturday** 10:00am to 10:30pm

**Sunday** 10:00am to 4:00pm



This is the **step free access entrance**.

There is **level access** and **auto doors** into the building from under the **canopy**.



This is the **ramp access entrance**. There is an **auto door**.

This entrance is on **Union Street**.



There is also **step access** here.

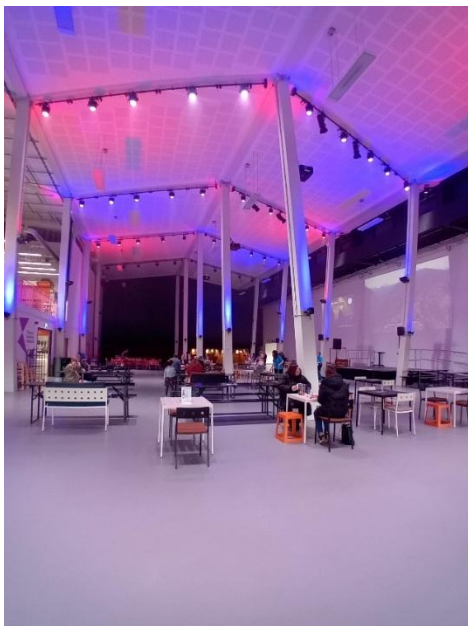

This is the **Main Hall**.

The hall has **coloured lighting**.

There is a **stage**. There are **video projections** on the wall.

There is **music** playing in the background.



Head into the main hall and **turn left.**

You will see the **Food and Beverage area.**



You can buy **Food and Drink** here.

There is a **bar** where you can buy alcohol and soft drinks.



There are places to **sit.**

This area may be **busy** and **noisy**. You may wish to wear **ear defenders.**



There are **male and female toilets**. These are in the **Main Hall** on the **ground floor**.

There is a **baby changing unit** in the **Female Toilets**.

This is in the first cubicle.



There is a **changing place** in the **Main Hall** on the **ground floor**.



There are **toilets** on the **ground floor** in the **Food and Beverage area**.



There are two **gender neutral toilets** on the right.



There is a **disabled toilet** at the end of the corridor.



There are **stairs** and a **lift** in the **Food and Beverage Area**.

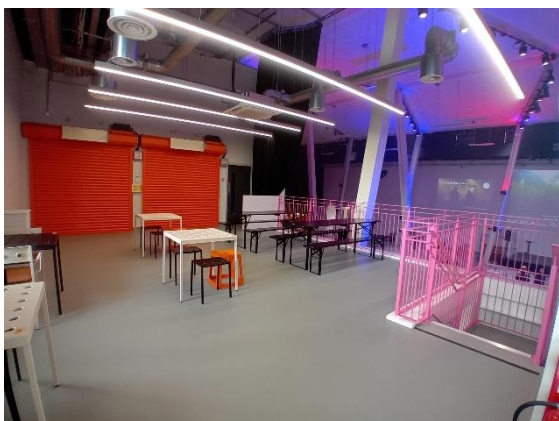
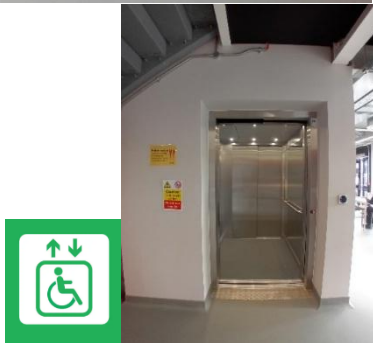

Head upstairs to the **Mezzanine Level**. There is more seating up here and food vendors.



This door leads to the **meeting rooms**.



There are **portable hearing loop** devices. Please ask a member of staff for help.

You can use our **WiFi for free**.

To do this you need to:

- turn your phone's WiFi on
- choose **WX Guest WiFi**
- the **Username** is guest
- the **Password** is wxevent
- **tick a box** to accept our terms and conditions
- choose '**connect**'.





**DOGS ON  
A LEAD  
ALLOWED**

The closest **disabled parking** is at:

- Borough Road car park
- Carter Street car park
- Trinity Walk Shopping Centre car park
- Ridings Shopping Centre

**Service dogs** are welcome in all areas of the venue.

**Well-behaved dogs on leads** are welcome in the **Main Hall** and **Food and Beverage**.

Only service dogs are able to enter the meeting rooms.



Our **staff** wear a **blue** uniform. You can ask them questions about the venue. You can ask them for **help** if you need it.

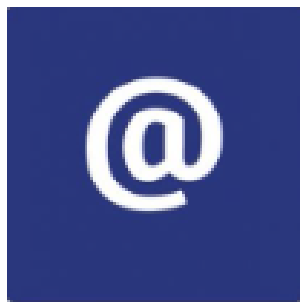

Contacting the venue

If you have any **questions about access** at Wakefield Exchange, you can visit: [Plan Your Visit | Wakefield Exchange](#)

You can also **email the team** at [hello@wxwakefield.co.uk](mailto:hello@wxwakefield.co.uk)